

unit:mm tolerance: $\pm 0.2\text{mm}$ angle tolerance: $\pm 1^\circ$ hole tolerance : $\pm 0.1\text{mm}$

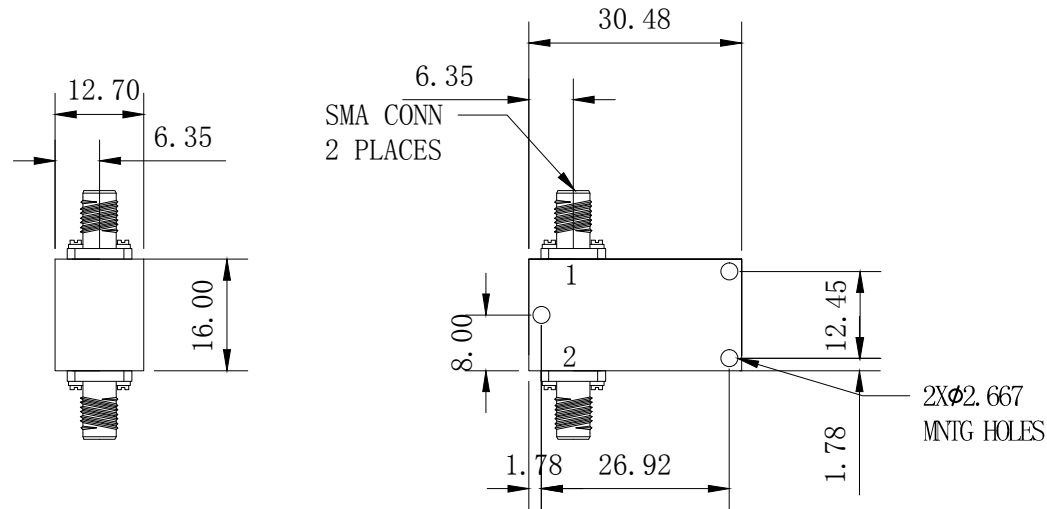

ODC-3180

SPECIFICATIONS

Frequency Range: 0.3-18.0GHz
 Insertion Loss: 0.8 dB Max
 Voltage: 50 Vdc Max
 VSWR: 1.30:1 Max

The Ocean microwave DC blocks are designed to inner-only topology and utilize our standard housings for fast turn manufacturing.

Designs are tested to 50 Ohms, and models range up to 18 GHz with a maximum voltage rating of 500 VDC.

The DC block series have good port matching performance with insertion loss is less than 0.7 dB and the VSWR is less than 1.4:1.

Any model can be customized to suit your specific performance or package requirements at little to no extra cost.

OCEAN MICROWAVE CORPORATION

OCEAN MICROWAVE CORPORATION
 1209 Caifuxihuan 58 NO, Caihuiying Bridge, Fengtai
 District, Beijing/China
 Tel: + 86-10-60290088 | Fax: + 86-10-63497801
<http://www.ecmicrowave.com> |
<http://www.oceanmicrowave.com>

DESCRIPTION: DC Block

MODEL NO.: ODC-3180

DIMENSIONS ARE IN
 MILLIMETERS
 DECIMAL TOLERANCE:

SIZE:

CAGE CODE:

REV CODE: A

SCALE: N / A

ALL SPECIFICATIONS ARE SUBJECT TO
 CHANGE WITHOUT NOTICE AT ANY TIME

SHEET 1 OF 1