

# Standard Horn Antenna

## OLB-650-15

This WR-650 standard gain horn antenna has a GAIN (14-16)dBi across the band and a square cover flange. It has a frequency of (1.12-1.70)GHz.

Standard gain horn antenna OLB-650-15 is known as a waveguide horn covers WG6, WR650, R14 bands. It is manufactured using the precision electrode cut copper sections providing accurate, consistent and reliable performance.

This antenna is suitable for Antenna Ranges ;Antenna Gain Measurements;System Setups.

HPBW of OLB-650-15 has a V-Plane & H-Plane beam width from 30 degree to 35 degree.



### Features

Precisely Machined and Gold Plated

Low VSWR

Light Weight

Linear Polarization

Low Return Loss

Rectangular Waveguide Interface

Lower sidelobes and symmetrical radiation patterns

### Applications

Antenna Ranges

Antenna Gain Measurements System Setups

Array Elements

### Electrical Specifications

Frequency Range(GHz)	1.12-1.70
Gain(dB)	15 Typ.
HPBW	H-Plane 30° / V-Plane 30°
Waveguide	WR650
Material	Al
Output	FDP14 N-F or SMA-F or 7/16-F
Size(mm) W x H x L	563x423x410 563x423x560
Net Weight(Kg)	4.4 Around 5.7 Around

### PATTERN

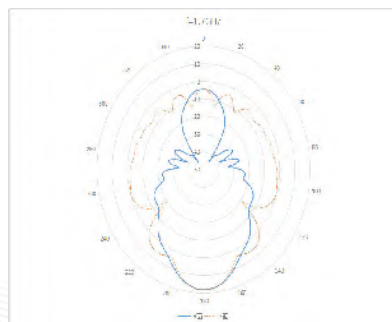
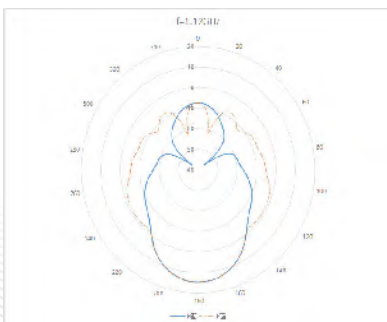

### PRODUCT DIMENSIONS

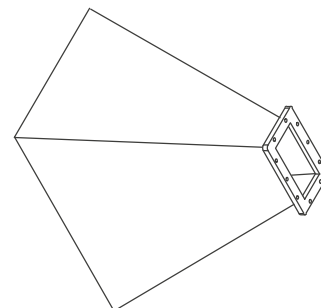
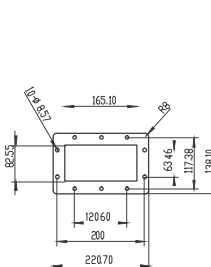
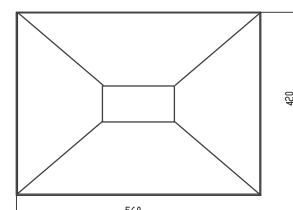
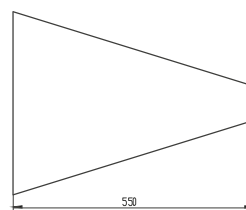

### GAIN

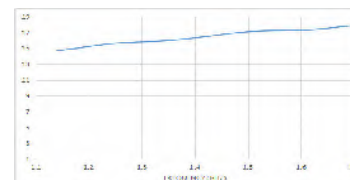

### VSWR

